



INSTALLATION INSTRUCTIONS

204-394 704-469 Airaid Oiled Media Filter
205-394 705-469 SynthaMax Dry Media Filter

2019-26 CHEVROLET / GMC
Silverado 1500 / Sierra 1500
L4-2.7L

NOT LEGAL FOR SALE OR USE ON ANY POLLUTION
CONTROLLED MOTOR VEHICLE IN CALIFORNIA OR
STATES ADOPTING CALIFORNIA EMISSION PROCEDURES.
See Airaid.com for CARB status on each part for a specific vehicle

TOOLS NEEDED:

- Ratchet, Extension
- 10mm deep socket
- 3mm allen key
- 4mm allen key
- t10 torx
- t20 torx
- Phillips screw driver
- Flat blade screw driver
- Pick

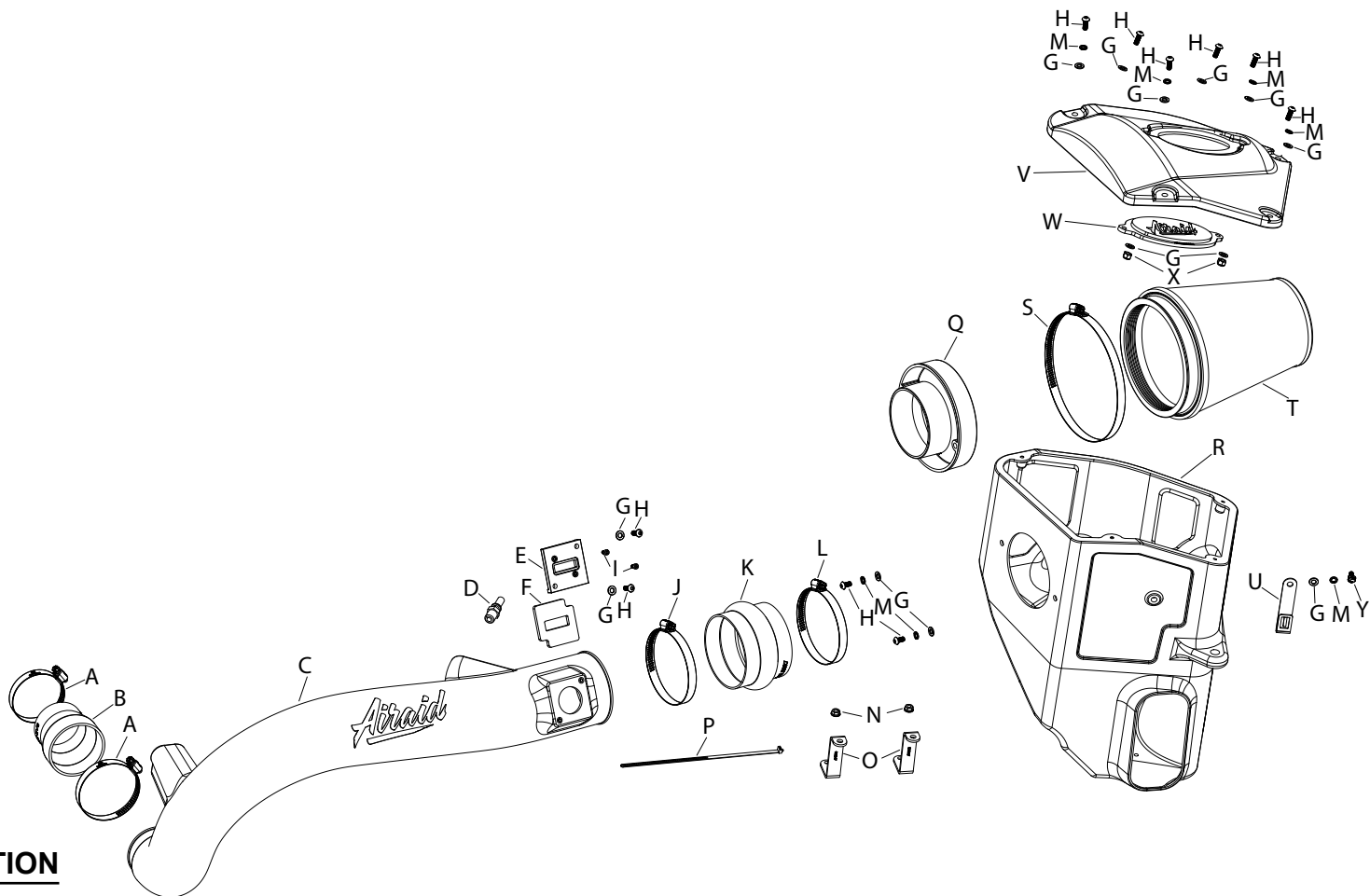

COMPONENT IDENTIFICATION

Description	Qty.	Part #	Description	Qty.	Part #	Description	Qty.	Part #
A HOSE CLAMP #64 STAINLESS	2	08645	J HOSE CLAMP #48	1	08601	S HOSE CLAMP #104	1	KITHS104
B HOSE; 3" TO 2.5"ID X 3"L	1	08713	K HOSE; HUMP 4"ID X 3"L	1	08418	T AIR FILTER	1	704/705-469
C TUBE; MT	1	087436	L HOSE CLAMP #40	1	08554	U BRACKET	1	064358A
D FITTING; .395" DISCONNECT	1	088025	M WASHER; M6 SPLIT LOCK	7	1-3025	V LID; MG	1	087423A
E ADAPTOR; MAF SENSOR	1	21515-1	N NUT; 6MM NYLOCK	2	07512	W PLATE; AIRAID LOGO	1	KITLOGOP-1
F GASKET; 3/16"	1	09069	O BRACKET; "Z"	2	010047	X NUT; M6, HEX	2	444.460.04
G WASHER; 6MM FLAT	13	08269	P CABLE TIES; 11" BLACK	1	21590	Y BOLT; M6 X 1 X 12MM HEX	1	07727
H SCREW; M6 X 20MM	10	KIT20BHC3060	Q ADAPTOR; #454	1	27300			
I BOLT; M4-.7 X 8MM	2	07733	R AIR BOX; MH	1	087424A			

Full color instructions can be viewed on our web site at Airaid.com. If you need any assistance please call 1-800-498-6951 to speak with a representative in our Customer Service Center before returning the product.

TO START:

1. Turn off the ignition and disconnect the negative battery cable.
NOTE: Disconnecting the negative battery cable erases pre-programmed electronic memories. Write down all memory settings before disconnecting the negative battery cable. Some radios will require an anti-theft code to be entered after the battery is reconnected. The anti-theft code is typically supplied with your owner's manual. In the event your vehicles anti-theft code cannot be recovered, contact an authorized dealership to obtain your vehicles anti-theft code.



2.Disconnect the mass air sensor electrical connection and loosen the hose clamp that secures the factory intake tube to the air filter housing.



3. Depress the locking tab and then disconnect the CCV pipe from the plenum.



4.Depress the locking tap and then disconnect the CCV pipe from the solenoid attached to the factory intake tube. Disconnect the solenoid electrical connection.



5.Loosen the hose clamp that secures intake tube to the turbo inlet.



6. Remove the two bolts that secure the engine cover to the engine and then remove the cover from the vehicle. These bolts will be reused in a later step.

Continued...



7. Remove the two nuts that secure the intake tube to the engine. Unhook the wiring harness from the intake tube and then remove the intake tube assembly from the vehicle. These nuts will be reused in a later step.



8. Remove the two bolts that secure the hood release latch handle and then remove the handle from the vehicle.



9. Remove the ten push pins that secure the upper radiator valence and then remove the valence from the vehicle.



10. Remove the push pin that secures the fresh air duct to the core support and then dislodge the duct from the air filter housing. This push pin will be reused in a later step.



11. Using a small pick or similar tool, release the locking tab that secures the wiring harness bulk connector to the air filter housing and then remove the harness from the housing.



12. Remove the nut that secures the air filter housing to the mounting bracket. This nut will be reused in a later step.



13. Install the provided bulk connector bracket onto the AIRAID air filter housing and secure with the provided hardware.



14. Install the filter adapter into the AIRAID filter housing and secure with the provided hardware.

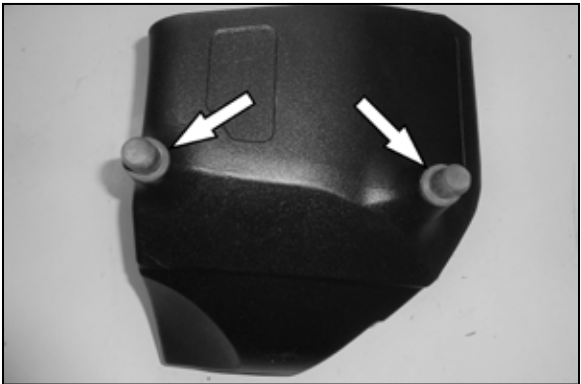

15. Remove both factory air filter housing bushings from the factory housing and install them onto the AIRAID filter housing as shown.



16. Install the AIRAID air filter housing into the vehicle and secure with the factory nut from step #12.

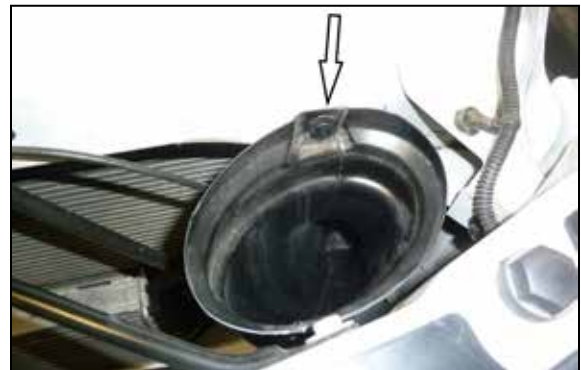

17. Install the fresh air intake duct into the AIRAID air filter housing and then secure it to the core support using the factory push pin.



18. Install the wiring harness bulk connector onto the bracket installed onto the AIRAID air filter housing.



19. Install the hump coupler onto the filter adapter and secure with the provided hose clamp.



20. Install the provided straight coupler onto the turbo inlet and secure with the provided hose clamp.



21. Install the provided quick connect fitting into the AIRAID intake tube.



22. Remove the mass air sensor from the factory housing and then install the sensor into the adapter provided along with the gasket.



23. Install the mass air sensor assembly into the AIRAID intake tube and secure with the provided hardware as shown in the photo.



24. Remove the CCV solenoid from the factory intake tube and install it into the K&N intake tube using the factory bolt.

Continued...



25. Install the intake tube assembly into the coupler at the air filter housing and then into the coupler at the turbo inlet, adjust the tube for best fit and then secure with the provided hose clamps.



26. Using the factory bolts and the nuts provided, secure the two provided "Z" brackets to the engine cover as shown.



27. Install the engine cover onto the engine and secure the brackets to the factory mounting studs using the factory nuts.



28. Connect the CCV tube to the quick connect fitting installed into the AIRAID intake tube.



29. Connect the CCV tube to the solenoid and connect the electrical connection.



30. Reconnect the mass air sensor electrical connection.



31. Install the AIRAID air filter onto the filter adapter and secure with the provided hose clamp.



32. Install the AIRAID window into the AIRAID filter housing lid using the provided hardware.



33. Install the AIRAID air filter housing lid onto the lower air filter housing using the provided hardware.



34. Reinstall the upper radiator valence and secure with the ten factory push pins.



35. Reinstall the hood latch lever and secure with the factory hardware.



36. Double check your work! Make sure there is no foreign material in the intake path. Make sure all clamps, hoses, bolts, and screws are tight. Double check the hood clearance! **Reconnect the negative battery cable!**

37. AIRAID AIR FILTER MONITOR LIGHT: Some vehicles are equipped with a "Air Filter Monitor" system that will send a message to the instrument cluster indicating that the air filter needs to be replaced. This system is calibrated for the OEM intake system and air filter and will not be accurate when AIRAID products are in use. Always refer to WWW.AIRAID.COM for AIRAID air filter service procedures. The "Air Filter Monitor" system must be disabled to prevent the monitor from setting on and causing a factory dealership visit reset the system. Follow the "Air Filter Monitor" system procedure listed in the factory owners manual.

Thank you for purchasing the Airaid Intake System. Contact Airaid @ (800) 498-6951 8:00 AM - 5:00 PM MST weekdays for questions regarding fit or instructions that are not clear to you. Your Airaid Intake System was carefully inspected and packaged. Check that no parts are missing, or were damaged during shipping. If any parts are missing, contact Airaid. The air filter element is protected from direct exposure to water and debris; care should be taken not to drive through deep water. **WATER INGESTION IS THE DRIVERS RESPONSIBILITY!** The air filter is reusable and should be cleaned periodically.

For your Oiled media filter we offer the Airaid Tune Up Kit!



P/N 790-551 Aerosol Spray
P/N 790-550 Squeeze Spray



NOT LEGAL FOR SALE OR USE ON ANY POLLUTION CONTROLLED MOTOR VEHICLE IN CALIFORNIA OR STATES ADOPTING CALIFORNIA EMISSION PROCEDURES.

See Airaid.com for CARB status on each part for a specific vehicle



Synthamax Air Filters do not require oil. Service air filter as needed by cleaning with common non-petroleum all-purpose household cleaner and water. Simple Green®, Formula 409® or equivalent works great. Apply cleaner to outside of air filter and allow to soak. Then flush filter clean from the inside out with a garden hose and repeat steps if necessary. Do not apply high pressure water or air to clean filter. Allow filter to air dry and reinstall.