



INSTALLATION INSTRUCTIONS

Not legal for sale or use in California on any pollution controlled motor vehicle.

77-6019KC NISSAN 2022-25 PATHFINDER V6-3.5L

TOOLS NEEDED:

- Ratchet
- Extension
- 10mm Socket
- Flat Blade Screw Driver
- Phillips Screw Driver

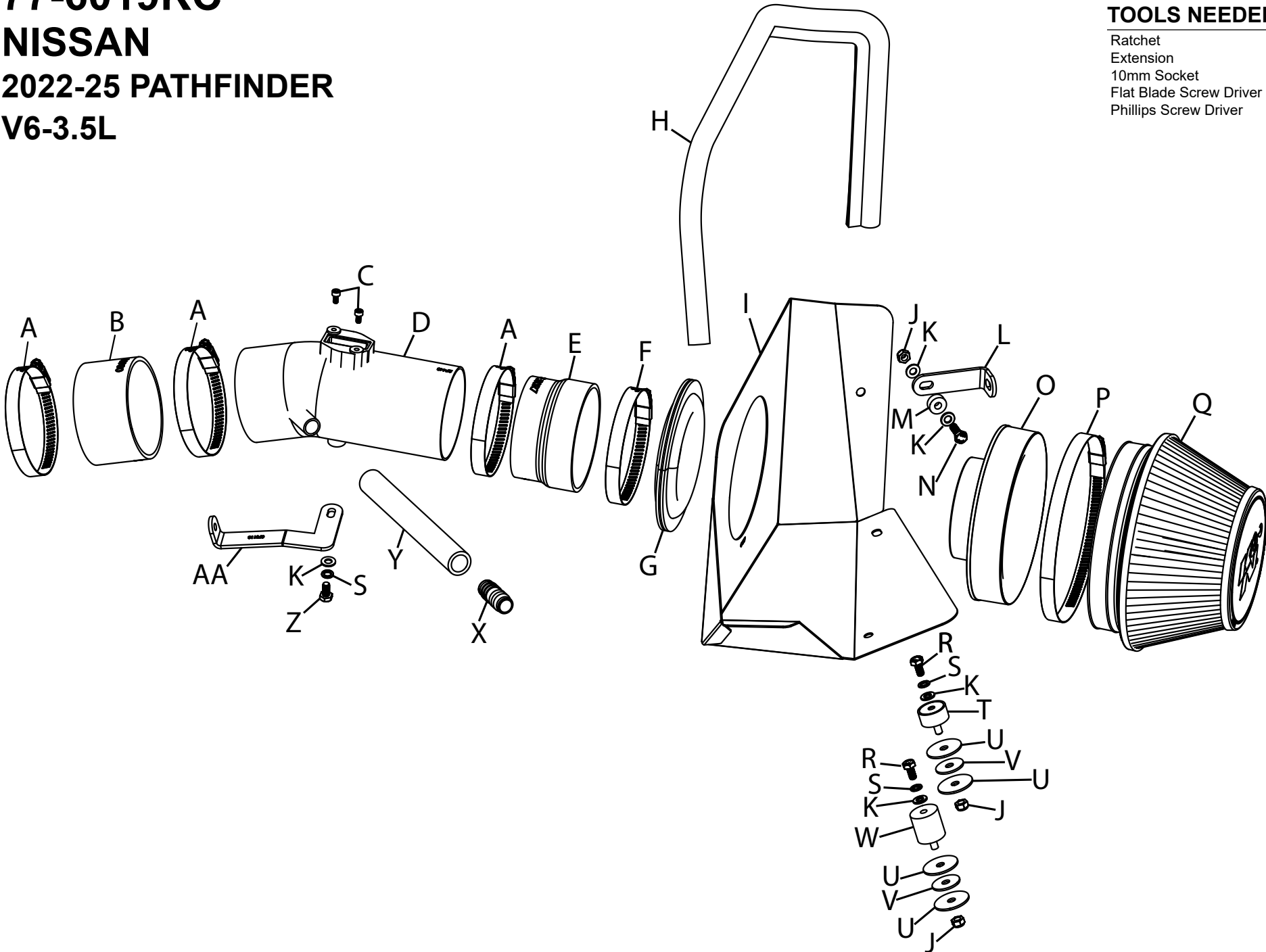

PARTS LIST:

Description	Qty.	Part #	Description	Qty.	Part #	Description	Qty.	Part #
A HOSE CLAMP; #52	3	08610	J NUT; 6MM NYLOCK, HEXHD	3	07512	S WASHER; 1/4"ID X 5/8"OD	3	08275
B HOSE; 3.25"ID X 2"L	1	08690	K WASHER; 1/4" LOCK	5	08198	T STUD; RUBBER, 1/2"L X 1"W	1	070228
C BOLT; M4-.7 X 8MM, ALNHD	2	07733	L BRACKET; "L"	1	07805A	U WASHER; 1.25"OD X .28 HOLE	4	08151
D TUBE; 3.25"OD X 7.75"L, AL	1	27443C	M SPACER; .625"OD X .250"ID	1	06555	V WASHER; 1" X .300 X .063	2	21685
E HOSE; 3.25"ID TO 3.5"ID X 2.25	1	084091	N BOLT; M6 X 1 X 20MM, HEX	1	07795	W STUD; RUBBER, M6 X 1	1	02033
F HOSE CLAMP; #56	1	08620	O ADAPTER; UNIVERSAL	1	21512-1	X FITTING; VENT, 5/8"OD	1	08048
G EDGE TRIM; (20"L)	1	102494	P HOSE CLAMP; #104	1	08697	Y HOSE; 5/8"ID X 7.5"L	1	084008
H EDGE TRIM; (44"L)	1	102486	Q AIR FILTER	1	RU-1009	Z BOLT; M6 X 1 X 12MM, HEXHD	1	07727
I HEAT SHIELD	1	074567	R BOLT; M6-1 X 16MM, HEX	2	07812	AA BRACKET; "L"	1	070113

If you need any assistance please call 1-800-858-3333 to speak with a representative in our Customer Service Center before returning the product.

NOTE: FAILURE TO FOLLOW INSTALLATION INSTRUCTIONS AND NOT USING THE PROVIDED HARDWARE MAY DAMAGE THE INTAKE TUBE, THROTTLE BODY AND ENGINE.

TO START:

1. Turn off the ignition and disconnect the negative battery cable.
NOTE: Disconnecting the negative battery cable erases pre-programmed electronic memories. Write down all memory settings before disconnecting the negative battery cable. Some radios will require an anti-theft code to be entered after the battery is reconnected. The anti-theft code is typically supplied with your owner's manual. In the event your vehicles anti-theft code cannot be recovered, contact an authorized dealership to obtain your vehicles anti-theft code.



2. Remove the two bolts that secure the fresh air duct to the core support and then remove the duct from the vehicle.



3. Release the two clips that secure the upper air filter housing.

Continued

INSTALLATION INSTRUCTIONS



4. Release the spring clamp that secures the CCV hose to the air filter housing and then disconnect the hose from the housing.



5. Loosen the hose clamp that secures the intake tube to the upper filter housing and disconnect the hose from the housing.



6. Position the upper housing and access the mass air sensor electrical connection. Disconnect the mass air sensor electrical connection and the remove the housing from the vehicle.

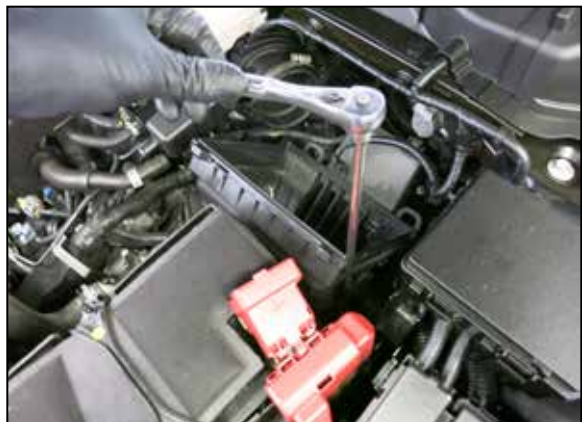

7. Loosen the bolt that secures the lower air filter housing to the bracket and then remove the lower housing from the vehicle.



8. Loosen the clamp that secures the factory intake tube to the throttle body and then remove the intake tube from the vehicle.



9. Remove the two-factory air filter housing mounting grommets.



10. The 1/2" and 1" rubber mounted studs will be assembled in the order shown onto the air filter housing mounting points.



11. Install the 1/2" rubber mounted stud onto the front housing mount and the 1" mounting stud onto the rear housing mount.



12. Remove the front lower throttle body mounting bolt.



13. Install the K&N intake tube mounting bracket onto the throttle body and secure with the factory bolt removed in the previous step.



14. Install the provided coupler onto the throttle body and secure with the provided hose clamp.



15. Install the provided edge trim into the hole and around the outside edge of the heat shield as shown. Some trimming of the edge trim will be necessary.



16. Install the heat shield mounting bracket onto the heatshield using the provided spacer and hardware.



17. Remove the bolt that secures the ground to the strut tower, do not remove the ground.



18. Set the heatshield into position on the mounting studs.



19. Align the mounting bracket with the ground location and then secure the bracket with the factory bolt removed from the ground. Be sure the ground is between the bracket and the strut tower, the ground should be in its original location.



20. Secure the heatshield to the mounting studs with the provided hardware.



21. Pass the K&N tube through the hole in the heat shield.



22. Remove the mass air sensor from the factory air filter housing and install it into the K&N intake tube using the provided screws.



23. Install the tube into the coupler and then align with the mounting bracket previously installed. Secure the tube to the bracket with the provided hardware and hose clamp.



24. Reconnect the mass air sensor electrical connection.



25. Install the radius filter adapter onto the intake tube with the provided coupler and hose clamps.



26. Install the K&N filter onto the filter adapter and secure with the provided hose clamp.



27. Install the provided hose mender into the factory CCV hose and secure with the factory clamp. Then install the provided CCV hose to hose mender and connect to the K&N intake tube.



28. Reinstall the factory fresh air intake duct and secure with the factory hardware.



29. Reconnect the vehicle's negative battery cable. Double check to make sure everything is tight and properly positioned before starting the vehicle.

30. It will be necessary for all K&N® high flow intake systems to be checked periodically for realignment, clearance and tightening of all connections. Failure to follow the above instructions or proper maintenance may void warranty.

ROAD TESTING:

1. Start the engine with the transmission in neutral or park, and the parking brake engaged. Listen for air leaks or odd noises. For air leaks secure hoses and connections. For odd noises, find cause and repair before proceeding. This kit will function identically to the factory system except for being louder and much more responsive.

2. Test drive the vehicle. Listen for odd noises or rattles and fix as necessary.

3. If road test is fine, you can now enjoy the added power and performance from your kit.

4. K&N Engineering, Inc., requires cleaning the intake system's air filter element every 100,000 miles. When used in dusty or off-road environments, our filters will require cleaning more often. We recommend that you visually inspect your filter once every 25,000 miles to determine if the screen is still visible. When the screen is no longer visible some place on the filter element, it is time to clean it. To clean and re-oil, purchase our filter Recharger® service kit, part number 99-5050 or 99-5000 and follow the easy instructions.