



# INSTALLATION INSTRUCTIONS

Not legal for sale or use in California on any pollution controlled motor vehicle.

## 77-1023KC TOYOTA 2024-26 TACOMA 2024-26 LAND CRUISER 2026 4RUNNER L4-2.4L TURBO

### TOOLS NEEDED:

Pick  
Flathead screwdriver  
Ratchet  
Extension  
11mm deep socket

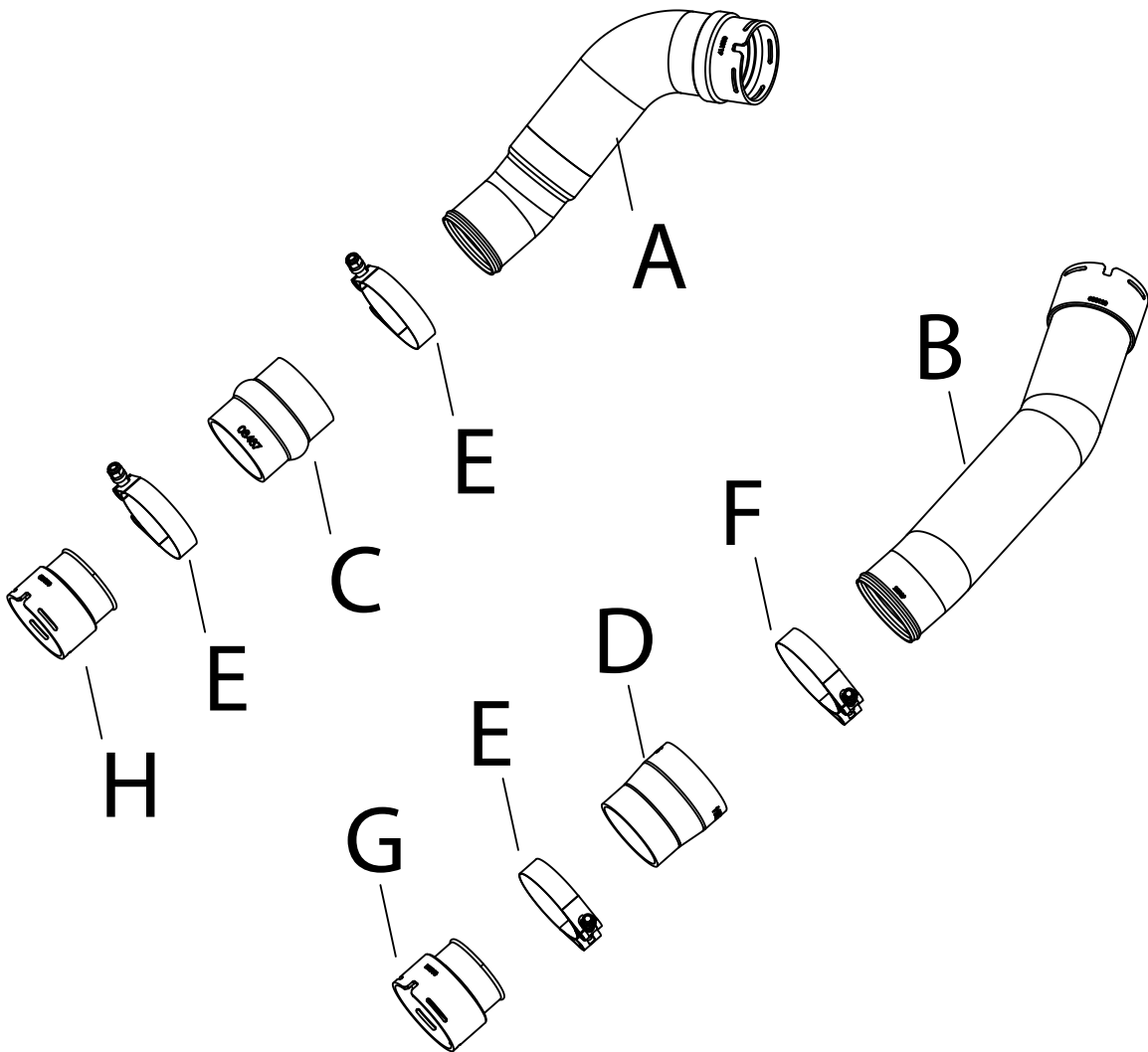

### PARTS LIST:

Description	Qty.	Part #	Description	Qty.	Part #	Description	Qty.	Part #
A HOT SIDE CHARGE PIPE	1	25938C	D HOSE; 2.5"/2.75" X 3"L	1	5-254	G COUPLER; QUICK CONNECT	1	088121
B COLD SIDE CHARGE PIPE	1	25939C	E CLAMP; T-BOLT	3	9445	H COUPLER; QUICK CONNECT	1	088120
C HOSE; HUMP 2.5" X 3.125"L	1	08487	F CLAMP; T-BOLT	1	21852			

If you need any assistance please call 1-800-858-3333 to speak with a representative in our Customer Service Center before returning the product.

**NOTE: FAILURE TO FOLLOW INSTALLATION INSTRUCTIONS AND NOT USING THE PROVIDED HARDWARE MAY DAMAGE THE INTAKE TUBE, THROTTLE BODY AND ENGINE.**

### TO START:

1. Turn off the ignition and disconnect the negative battery cable.  
**NOTE: Disconnecting the negative battery cable erases pre-programmed electronic memories. Write down all memory settings before disconnecting the negative battery cable. Some radios will require an anti-theft code to be entered after the battery is reconnected. The anti-theft code is typically supplied with your owner's manual. In the event your vehicles anti-theft code cannot be recovered, contact an authorized dealership to obtain your vehicles anti-theft code.**



2. Release the retaining clip that secures the "Cold Side" charge tube to the intercooler and intake pipe on the engine by pushing the ears down into the locks on the coupler.

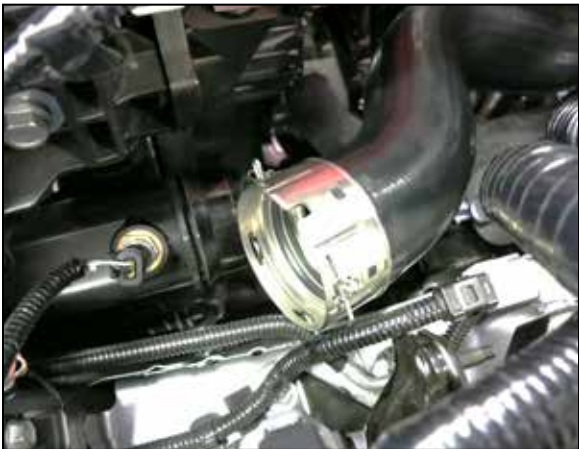

3. Pull the "Cold Side" charge tube away from the intercooler to disconnect it from the outlet.



4. Remove the cold side charge tube from the vehicle.



5. Release the retaining clips on the “Hot Side” charge tube in the same manner as the “Cold Side” and then remove the “Hot Side” charge tube from the vehicle.



6. Remove the retaining clip and O-ring from the inter cooler side of the “Hot Side” charge tube and install them into the K&N “Hot Side” Charge tube inter cooler quick coupler 088120 as shown. NOTE: notice the direction the lip is pointed on the O-ring and be sure to position the same direction in the K&N coupler.



7. Remove the retaining clip and O-ring from the engine side of the factory “Hot Side” charge tube and install them into the “Hot Side” K&N charge tube. NOTE: notice the direction the lip is pointed on the O-ring and be sure to position the same direction in the K&N coupler.



8. Install the hump coupler onto the K&N “Hot Side” inter cooler quick connector 088120 and secure with the provided hose clamp.



9. Install the “Hot Side” quick connector assembly onto the inter cooler as shown. Push the coupler onto the inter cooler until an audible “click” is heard as the retaining clip locks onto the inter cooler inlet.



10. Install the K&N “Hot Side” charge tube into the coupler, then position the tube onto the turbo outlet and push the tube onto the outlet until an audible “click” is heard as the retaining clip locks onto the outlet. Position the tube and coupler for best fit and then secure the hose clamps.



11. Remove the O-rings and retaining clips from the “Cold Side” charge tube and install them into the K&N “Cold Side” charge tube and quick coupler 088121. NOTE: notice the direction the lip is pointed on the O-ring and be sure to position the same direction in the K&N coupler.



12. Install the provided step coupler onto the K&N “Cold Side” inter cooler quick connector 088121.



13. Install the “Cold Side” quick connector assembly onto the inter cooler outlet. Push the coupler onto the inter cooler until an audible “click” is heard as the retaining clip locks onto the inter cooler outlet.





14. Install the K&N “Cold Side” charge tube into the coupler, then position the tube onto the engine inlet and push the tube onto the inlet until an audible “click” is heard as the retaining clip locks onto the inlet. Position the tube and coupler for best fit and then secure the hose clamps. Position the “Cold Side” charge tube for best fit and then secure the hose clamps.



15. Apply the K&N decal to the “Cold Side” charge tube.



16. Reconnect the vehicle’s negative battery cable. Double check to make sure everything is tight and properly positioned before starting the vehicle.

17. It will be necessary for all K&N® high flow intake systems to be checked periodically for realignment, clearance and tightening of all connections. Failure to follow the above instructions or proper maintenance may void warranty.

**ROAD TESTING:**

1. Start the engine with the transmission in neutral or park, and the parking brake engaged. Listen for air leaks or odd noises. For air leaks secure hoses and connections. For odd noises, find cause and repair before proceeding. This kit will function identically to the factory system except for being louder and much more responsive.
2. Test drive the vehicle. Listen for odd noises or rattles and fix as necessary.
3. If road test is fine, you can now enjoy the added power and performance from your kit.
4. K&N Engineering, Inc., requires cleaning the intake system’s air filter element every 100,000 miles. When used in dusty or off-road environments, our filters will require cleaning more often. We recommend that you visually inspect your filter once every 25,000 miles to determine if the screen is still visible. When the screen is no longer visible some place on the filter element, it is time to clean it. To clean and re-oil, purchase our filter Recharger® service kit, part number 99-5050 or 99-5000 and follow the easy instructions.