



INSTALLATION INSTRUCTIONS

Not legal for sale or use in California on any pollution controlled motor vehicle.

69-2028TC BMW

2017-25 230i
2017-21 230i xDrive
2017-25 330i
2020 330i GT
2017-19 330i GT xDrive
2017-20 330i xDrive
2017-20 430i
2017-20 430i xDrive Gran Coupe
2017-20 430i Drive
2017-20 430i Gran Coupe
L4-2.0

NOTE: This kit was not designed to fit vehicles with a body lift.

TOOLS NEEDED:

Flat Blade Screw driver
cutters
10mm wrench
3mm wrench
4mm wrench
T20 torx

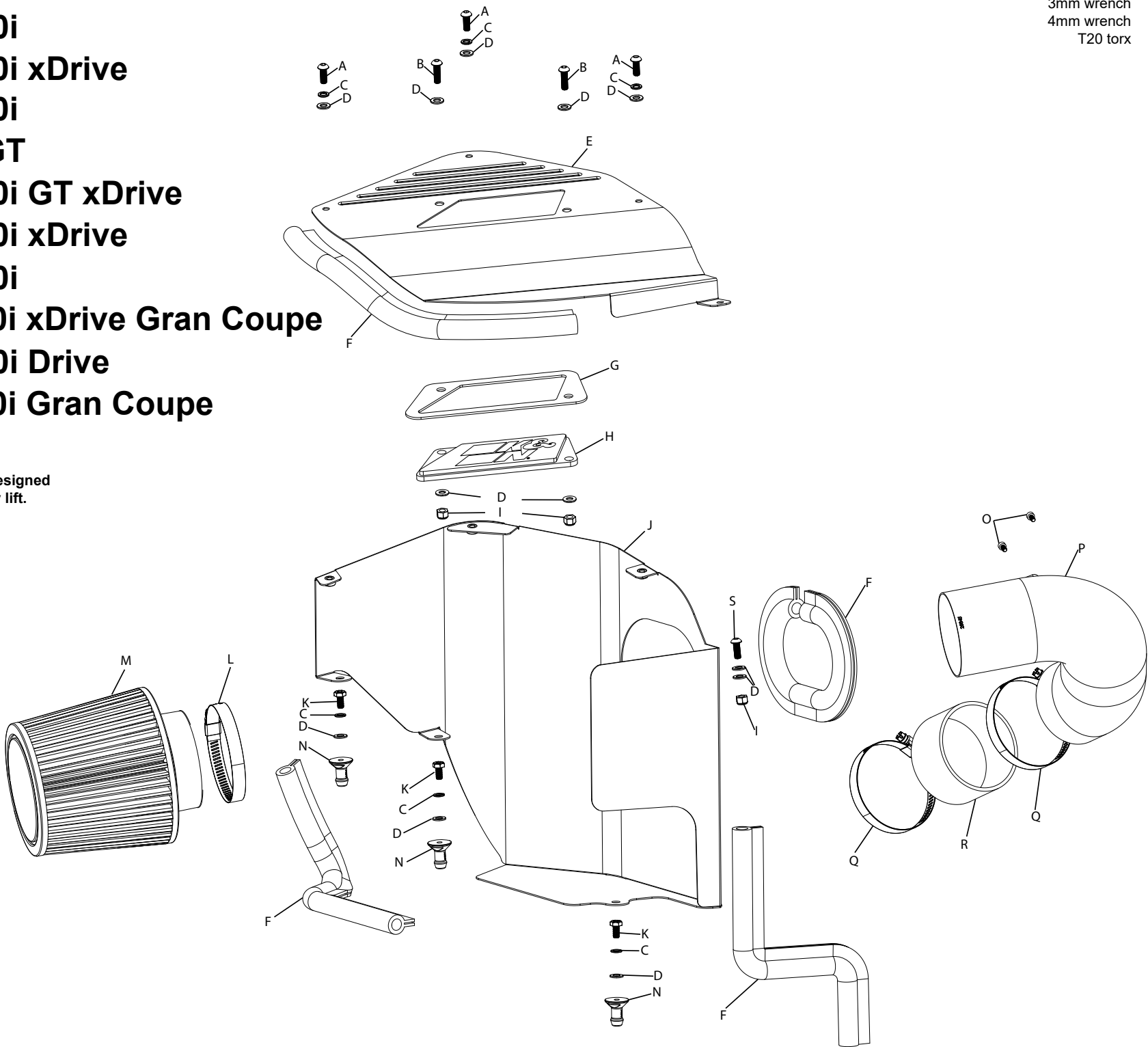

PARTS LIST:

Description	Qty.	Part #	Description	Qty.	Part #	Description	Qty.	Part #
A BOLT; M6-1 X 12MM, BTNHD	3	07794	H PLATE; K&N LOGO CLEAR	1	08351-1	O BOLT; M4-.7 X 8MM, ALNHD	2	07733
B SCREW; M6 X 20MM, BTNHD	2	KIT20BHC3060	I NUT; 6MM NYLOCK, HEXHD	3	07512	P TUBE; 3.25"OD X 13"L	1	25845C
C WASHER; M6 SPLIT LOCK ZINC	6	1-3025	J HEAT SHIELD	1	074502	Q HOSE CLAMP; #52	2	08610
D WASHER; 6MM FLAT	12	08269	K BOLT; M6 X 1 X 12MM, HEXHD	3	07727	R HOSE; SILICONE	1	5-326
E LID; MILD STL	1	074503	L HOSE CLAMP; #56	1	08620	S BOLT; M6 X 1 X 16MM, BTNHD	1	07730
F EDGE TRIM; (61"L)	1	102492	M AIR FILTER	1	RU-4490			
G SPACER; ALUM CLEAR BADGE	1	7-364	N MOUNT; PLASTIC	3	8-186-1			

If you need any assistance please call 1-800-858-3333 to speak with a representative in our Customer Service Center before returning the product.

NOTE: FAILURE TO FOLLOW INSTALLATION INSTRUCTIONS AND NOT USING THE PROVIDED HARDWARE MAY DAMAGE THE INTAKE TUBE, THROTTLE BODY AND ENGINE.

TO START:

1. Turn off the ignition and disconnect the negative battery cable.
NOTE: Disconnecting the negative battery cable erases pre-programmed electronic memories. Write down all memory settings before disconnecting the negative battery cable. Some radios will require an anti-theft code to be entered after the battery is reconnected. The anti-theft code is typically supplied with your owner's manual. In the event your vehicles anti-theft code cannot be recovered, contact an authorized dealership to obtain your vehicles anti-theft code.



2. Lift up and then remove the engine cover.



3. Release the locking tab and then disconnect the mass air sensor electrical connection.

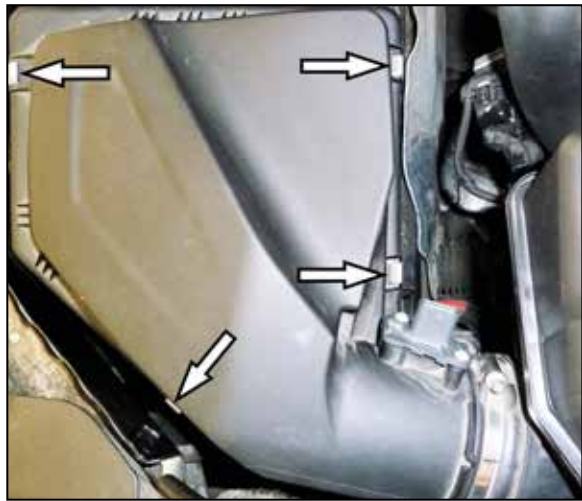

4. Release the four locking clips that secure the air filter lid, loosen the hose clamp that secures the intake hose and then remove the lid from the vehicle.



5. Pull the lower half of the air filter housing straight up and remove it from the vehicle.



6. Cut the one-time use clamp that secures the intake hose to the intake plenum and then remove the intake tube from the vehicle.



7. Install the three mounting studs provided onto the heat shield as shown.

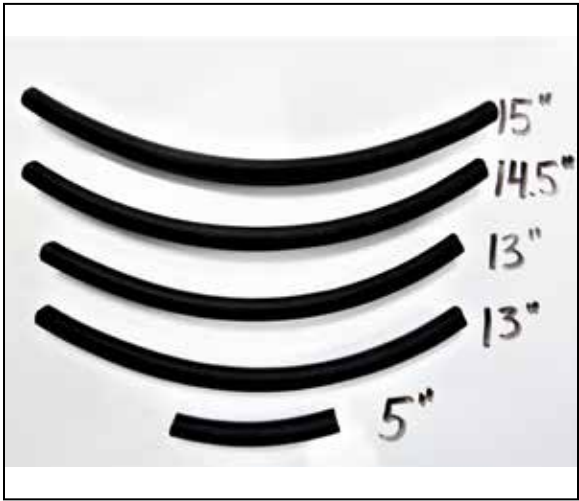

8. Cut the provided edge trim into sections as shown.



9. Install the edge trim onto the heat shield as shown.



10. Install the heat shield into the vehicle so the mounting studs insert into the factory mounting grommets.



11. Install the provided coupler onto the plenum and secure with the provided hose clamp.



12. Remove the mass air sensor from the factory air filter housing and install it into the K&N intake tube and secure with the provided hardware.



13. Install the intake tube through the hole in the heat shield and then into the coupler. Do not secure the hose clamp at this time. Connect the mass air sensor electrical connection.



14. Install the air filter onto the intake tube and secure with the provided hose clamp. Adjust the tube for best fit and then secure the hose clamp.



15. Install the K&N window into the lid and then install the edge trim as shown.



16. Install the lid onto the heat shield and secure with the provided hardware.



17. Reconnect the vehicle's negative battery cable. Double check to make sure everything is tight and properly positioned before starting the vehicle.

18. It will be necessary for all K&N® high flow intake systems to be checked periodically for realignment, clearance and tightening of all connections. Failure to follow the above instructions or proper maintenance may void warranty.

ROAD TESTING:

1. Start the engine with the transmission in neutral or park, and the parking brake engaged. Listen for air leaks or odd noises. For air leaks secure hoses and connections. For odd noises, find cause and repair before proceeding. This kit will function identically to the factory system except for being louder and much more responsive.
2. Test drive the vehicle. Listen for odd noises or rattles and fix as necessary.
3. If road test is fine, you can now enjoy the added power and performance from your kit.
4. K&N Engineering, Inc., requires cleaning the intake system's air filter element every 100,000 miles. When used in dusty or off-road environments, our filters will require cleaning more often. We recommend that you visually inspect your filter once every 25,000 miles to determine if the screen is still visible. When the screen is no longer visible some place on the filter element, it is time to clean it. To clean and re-oil, purchase our filter Recharger® service kit, part number 99-5050 or 99-5000 and follow the easy instructions.