



# INSTALLATION INSTRUCTIONS

Not legal for sale or use in California on any pollution controlled motor vehicle.

## 63-9042 TOYOTA 2022-26 TUNDRA 2023-26 SEQUOIA V6-3.4L TWIN TURBO

NOTE: This kit was not designed to fit vehicles with a body lift.

### TOOLS NEEDED:

- Ratchet
- Extension
- 8mm Socket 10mm
- Socket 3mm Allen
- Key 4mm Allen Key
- Flat Blade Screw Driver
- Phillips Screw Driver

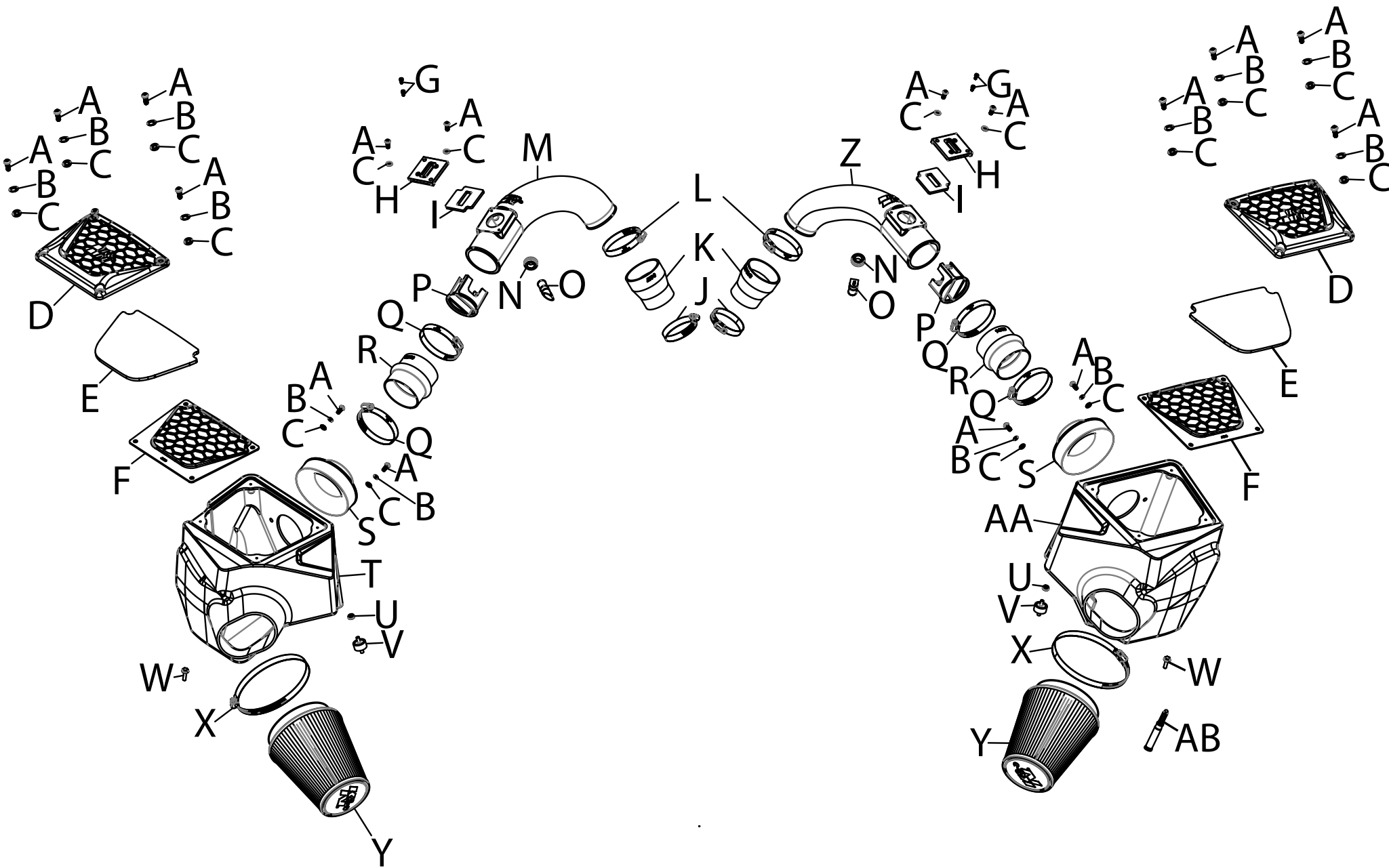

### PARTS LIST:

Description	Qty.	Part #	Description	Qty.	Part #	Description	Qty.	Part #
A BOLT; M6 X 1 X 16MM BTNHD	16	07730	J HOSE CLAMP; #36	2	08530	S ADAPTER; FILTER	2	21569
B WASHER; M6, SPLIT LOCK	12	1-3025	K HOSE; ADAPTER 2.25"/2.75"X3"	2	AEM-5-227	T AIRBOX; RIGHT SIDE	1	087561
C WASHER; 6MM FLAT	16	08269	L HOSE CLAMP; #44	2	08577	U NUT; M6, HEX	2	444.460.04
D FRAME; PRECLEANER TOP	2	088208	M TUBE; RIGHT SIDE	1	087563	V STUD; M6-1.00 RUBBER	2	07027
E INSERT; FOAM	2	971975	N GROMMET; 9/16"ID	2	AIR-KITGRMT02	W BOLT; M6-1 X 20, HEX/FLANGE	2	1-2038
F FRAME; PRECLEANER BTM	2	088207	O INSERT; CCV, NYLON	2	088206	X CLAMP; #88	2	AIR-KITS88
G BOLT; M4-.7 X 8MM, ALNCAP	4	07733	P MAF INSERT; 2.59"OD	2	9-21070	Y AIR FILTER	2	RU-2800
H ADAPTER; MAF SENSOR	2	21515-1	Q HOSE CLAMP; #48	4	08601	Z TUBE; LEFT SIDE	1	087562
I GASKET; 3/16" PORON	2	09069	R HOSE; HUMPH 3"ID X 2.5"L	2	087121	AA AIRBOX; LEFT SIDE	1	087560
						AB SUPER GLUE	1	409

If you need any assistance please call 1-800-858-3333 to speak with a representative in our Customer Service Center before returning the product.

NOTE: FAILURE TO FOLLOW INSTALLATION INSTRUCTIONS AND NOT USING THE PROVIDED HARDWARE MAY DAMAGE THE INTAKE TUBE, THROTTLE BODY AND ENGINE.



Continued

INSTALLATION INSTRUCTIONS

TO START:

1. Turn off the ignition and disconnect the negative battery cable.  
**NOTE: Disconnecting the negative battery cable erases pre-programmed electronic memories. Write down all memory settings before disconnecting the negative battery cable. Some radios will require an anti-theft code to be entered after the battery is reconnected. The anti-theft code is typically supplied with your owner's manual. In the event your vehicles anti-theft code cannot be recovered, contact an authorized dealership to obtain your vehicles anti-theft code.**



2. Disconnect the passenger and driver side mass air sensor electrical connection and unhook the harness's mounting clips.



3. Release the retaining clips that secure the upper air filter housings.



4. Loosen the hose clamps that secure the factory upper intake tubes and then remove the upper housings and intake tubes. **NOTE: K&N Engineering, Inc., recommends that customers do not discard factory air intake.**



5. Disconnect the PCV hose from the passenger side lower intake tube, Remove the intake tube mounting bolt then loosen the hose clamp securing the intake tube to the turbo inlet and remove the tube from the vehicle.



6. Disconnect the PCV hose from the driver side lower intake tube, Remove the intake tube mounting bolt then loosen the hose clamp securing the intake tube to the turbo inlet and remove the tube from the vehicle.



7. Remove the bolt that secures the driver side intake tube mounting bracket and then remove the bracket from the vehicle.



8. Remove the three air filter housing mounting studs from both the left and right sides.



9. Install the provided couplers onto the turbo inlets and secure with the provided hose clamps.



10. Install the filter adapters into the K&N air filter housings and secure with the provided hardware.





11. Install the provided rubber mounted studs into the rear most factory air box mounting stud locations.



12. Install the K&N air filter housings onto the rubber mounted studs and then secure the housing with the provided hardware.



13. Install the provided hump couplers onto the filter adapters and secure with the provided hose clamps.



14. Install the CCV inserts into the K&N intake tubes with the provided grommets. Be sure the "notch" located on the bead of the insert is aligned as shown in the photos, the notch is to be towards the inlet end (towards the mass air sensor) of the tube.



15. Using the provided adapter plates and gaskets, install the mass air sensors into the K&N intake tubes as shown.



16. Apply four drops of the provide super glue to the lip of the MAF sensor grids then, install the mass air sensor grids into the K&N intake tubes as shown.



17. Install the K&N intake tubes into the couplers and adjust for best fit then secure with the provided hose clamps.



18. Connect the factory CCV hoses to the fittings installed into the K&N intake tubes. Reconnect the mass air sensor electrical connections.



19. Install the K&N air filters onto the filter adapters and secure with the provided hose clamps.



20. Assemble the two lid and foam lids and secure them to the air filter housings with the provided hardware.





21. Reconnect the vehicle's negative battery cable. Double check to make sure everything is tight and properly positioned before starting the vehicle.

22. It will be necessary for all K&N® high flow intake systems to be checked periodically for realignment, clearance and tightening of all connections. Failure to follow the above instructions or proper maintenance may void warranty.

**ROAD TESTING:**

- 1. Start the engine with the transmission in neutral or park, and the parking brake engaged. Listen for air leaks or odd noises. For air leaks secure hoses and connections. For odd noises, find cause and repair before proceeding. This kit will function identically to the factory system except for being louder and much more responsive.
- 2. Test drive the vehicle. Listen for odd noises or rattles and fix as necessary.
- 3. If road test is fine, you can now enjoy the added power and performance from your kit.
- 4. K&N Engineering, Inc., requires cleaning the intake system's air filter element every 100,000 miles. When used in dusty or off-road environments, our filters will require cleaning more often. We recommend that you visually inspect your filter once every 25,000 miles to determine if the screen is still visible. When the screen is no longer visible some place on the filter element, it is time to clean it. To clean and re-oil, purchase our filter Recharger® service kit, part number 99-5050 or 99-5000 and follow the easy instructions.