



# INSTALLATION INSTRUCTIONS

Not legal for sale or use in California on any pollution controlled motor vehicle.

## 63-1564 DODGER / CHRYSLER 2011-23 CHARGER 2011-23 CHALLENGER 2011-23 300 V6-3.6L

### TOOLS NEEDED:

- 4mm Allen Wrench
- 10mm Socket
- 14mm Socket
- 10mm Wrench
- Extension
- Ratchet
- Flat Blade Screwdriver

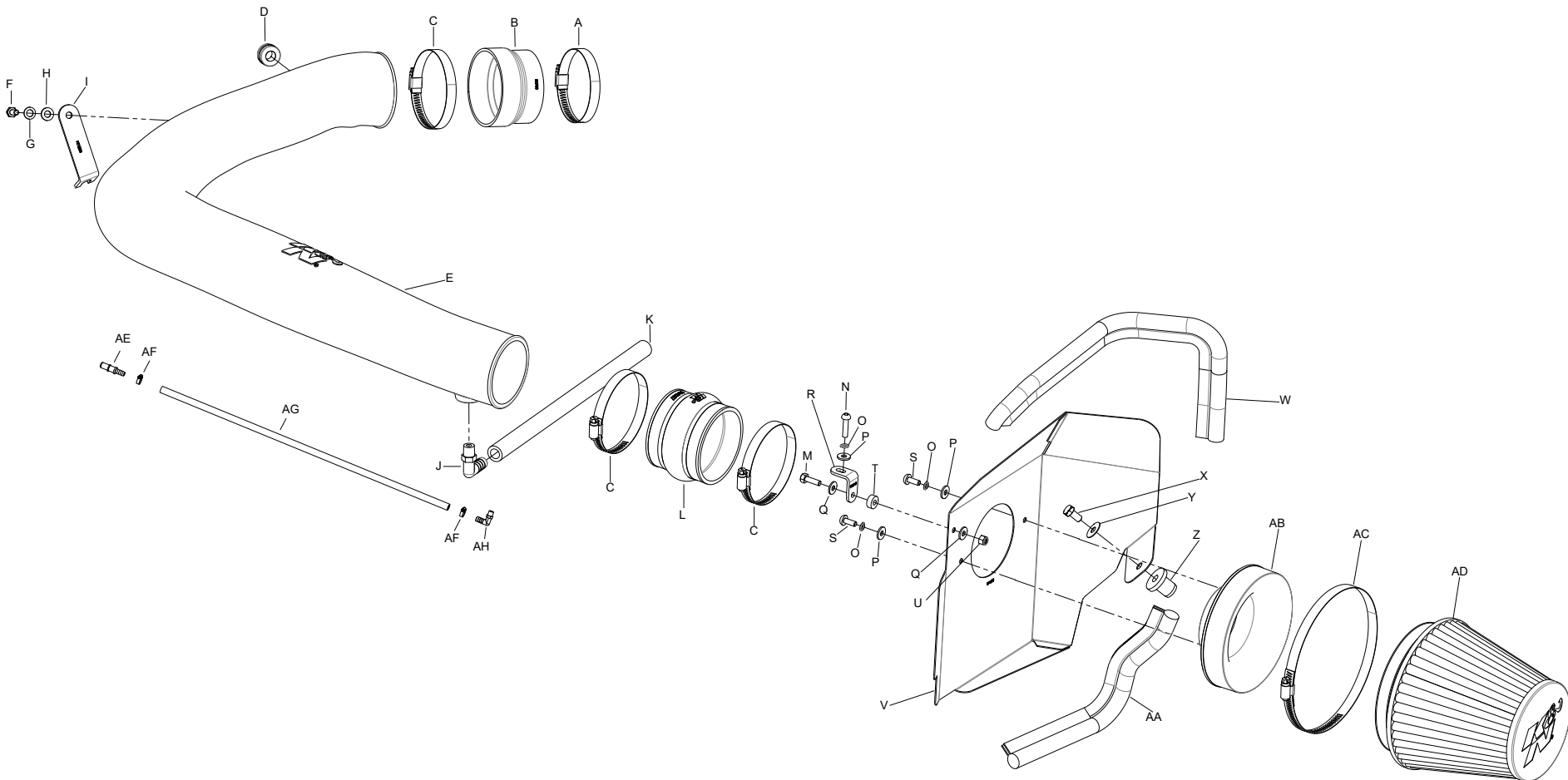

### PARTS LIST:

Description	Qty.	Part #			
A HOSE CLAMP #52	1	08610	R BRACKET, "L," SML	1	070066A
B HOSE; 3.25" ID TO 3.5" ID X 2.25"L BLK	1	084091	S BOLT; M6 X 1 X 16MM, BTNHD	2	07730
C HOSE CLAMP #56	3	08620	T SPACER; .625" OD X .250" ID X .250"L,	1	06555
D GROMMET; 1"OD, 1/2"ID, 1/2"THK	1	08064	U HEAT SHIELD	1	074088A
E INTAKE TUBE; (II)	1	087251A	V NUT; 6MM NYLOCK, HEXHEAD	1	07512
F BOLT; 8MM -1.25 X 16MM, HEXHEAD	1	07844	W EDGE TRIM; (20"L)	1	102494
G WASHER; 8MM SPRING (WAVE)	1	08239	X BOLT; 3/8"-16 X 1-1/4"L HEX HEAD BOLT	1	07779
H WASHER; 8MM FLAT	1	08272	Y WASHER; 3/8" FLAT WASHER	1	08134
I BRACKET; "L"	1	083154A	Z INSERT; 3/8-16" X 3/4 X 15/16L; RUBBER	1	08163
J FITTING; VENT 1/4NPT, 90DEG.,5/8" HOSE BARB	1	08525-1	AA EDGE TRIM; (15"L)	1	102474
K HOSE; 5/8" ID X 14" L	1	084083	AB ADAPTER; UNIVERSAL, 6" FILTER 3.5" COUPLER	1	21512-1
L HOSE; HUMP 3.5" ID X 3"L	1	084057	AC HOSE CLAMP # 104	1	08697
M BOLT; M6 X 1 X 20MM HEX	1	07795	AD AIR FILTER	1	RU-1042
N BOLT; M6-1.00 X 25MM BTNHD	1	07729	AE FITTING; VENT, 1/2" BARB QUICK CONNECT	1	82629
O WASHER; 6MM FLAT	2	08269	AF HOSE CLAMP; #6 MINI	2	08407
P WASHER, M6 SPLIT LOCK ZINC	3	1-3025	AG HOSE; 1/2"ID X 35"L	1	5-5035
Q WASHER; 1/4" ID X 5/8" OD -SAE	3	08275	AH VENT; 90 DEG, 1/2"HOSE, 1/4"NPT, BLACK	1	08110FK

If you need any assistance please call 1-800-858-3333 to speak with a representative in our Customer Service Center before returning the product.

NOTE: FAILURE TO FOLLOW INSTALLATION INSTRUCTIONS AND NOT USING THE PROVIDED HARDWARE MAY DAMAGE THE INTAKE TUBE, THROTTLE BODY AND ENGINE.

### TO START:

1. Turn off the ignition and disconnect the negative battery cable.  
**NOTE: Disconnecting the negative battery cable erases pre-programmed electronic memories. Write down all memory settings before disconnecting the negative battery cable. Some radios will require an anti-theft code to be entered after the battery is reconnected. The anti-theft code is typically supplied with your owner's manual. In the event your vehicles' anti-theft code cannot be recovered, contact an authorized dealership to obtain your vehicles anti-theft code.**



2. Lift up and remove the engine cover.



3. Disconnect the inlet air temperature sensor electrical connection.



4. Disconnect the crank case vent hose from the air filter housing.  
**NOTE: On later models the crank case vent line connection will be near the throttle body.**



5. Loosen the hose clamp that secures the intake tube to the throttle body.



6. Remove the bolt that secures the air filter housing to the core support.



7. Remove the complete stock intake system from the vehicle.  
**NOTE: K&N Engineering, Inc., recommends that customers do not discard factory air intake.**

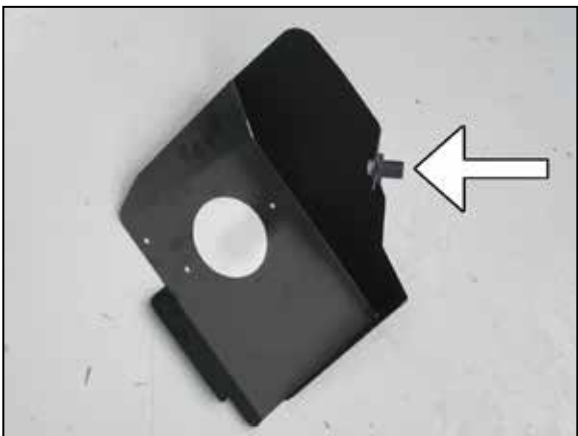

8. Install the inserted nut onto the heat shield using the provided hardware as shown.

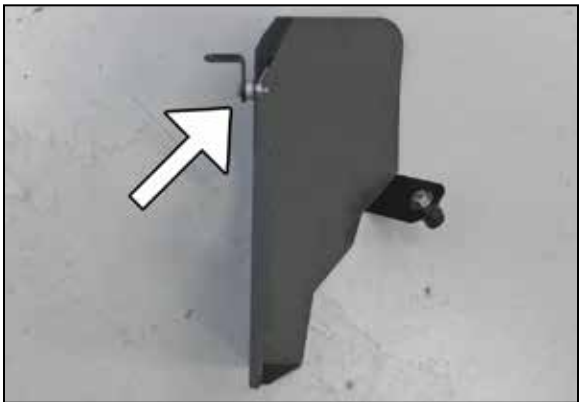

9. Install the heat shield mounting bracket (070066A) onto the heat shield as shown using the provided hardware and spacer.



10. Install the provided longer edge trim onto the top of the heat shield as shown.  
**NOTE: trimming of the edge trim will be necessary.**

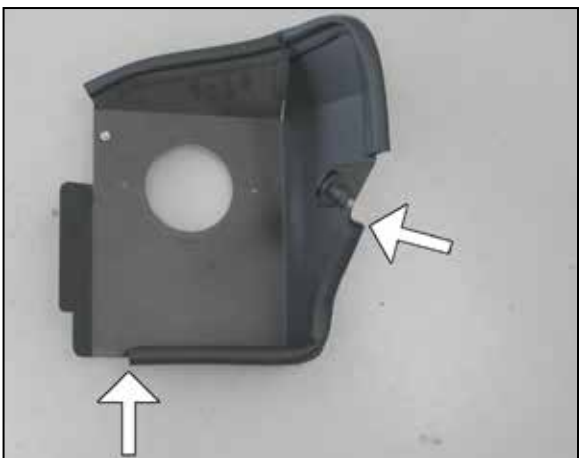

11. Install the provided shorter edge trim onto the bottom of the heat shield as shown.  
**NOTE: trimming of the edge trim will be necessary.**



12. Install the filter adapter into the heat shield and secure with the provided hardware.



13. Install the silicone hump hose (084057) onto the filter adapter and secure with the provided hose clamp.

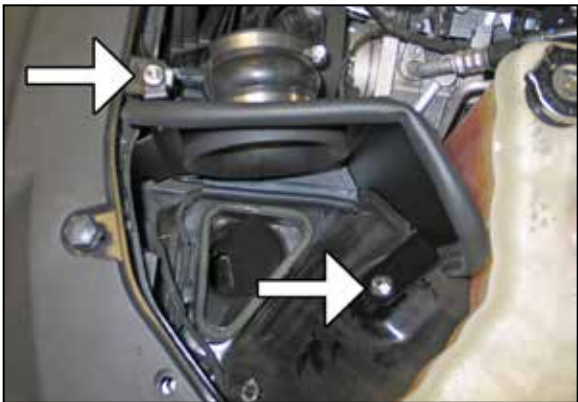

14. Install the heat shield assembly onto the inner fender; secure the mounting bracket to the factory air box mounting location and secure with the provided hardware. Place the insert nut into the hole in the inner fender and tighten the bolt to secure.



15. Install the provided silicone hose (084091) onto the throttle body and secure with the provided hose clamp.

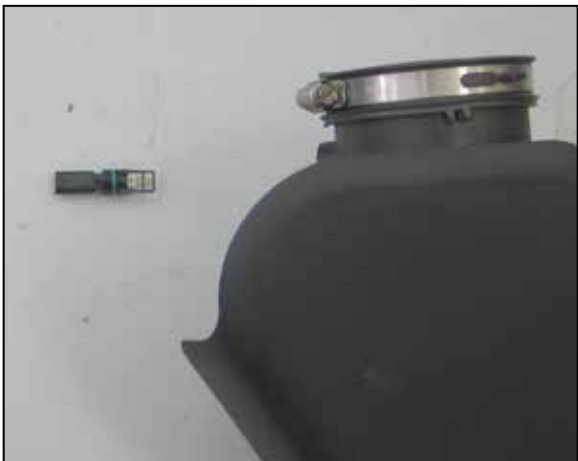

16. Rotate the inlet air temperature sensor counter clockwise and then remove from the factory intake tube.  
**NOTE: The inlet air temperature sensor is very fragile.**



17. Install the provided grommet and inlet air temperature sensor into the K&N® intake tube as shown.  
**NOTE: The inlet air temperature sensor is very fragile. Be sure to remove the factory O-ring from the inlet air temperature sensor before installing it into the grommet.**





18. Install the 90° NPT fitting into the K&N® intake tube as shown.  
**NOTE: NPT fittings are easy to cross thread. Install the vent fitting “hand” tight, then turn it two complete turns with a wrench.**



19. Remove the intake plenum mounting grommet from the intake plenum.

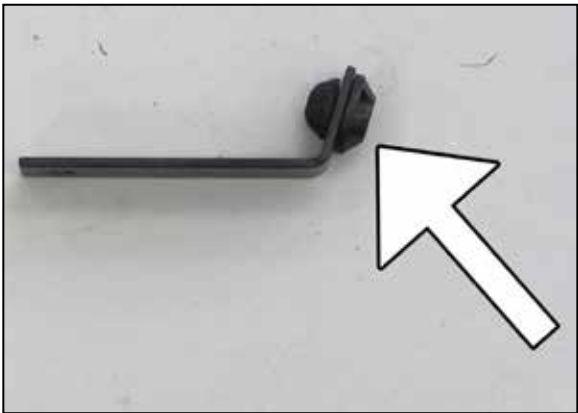

20. Install the mounting grommet from the intake plenum into the provided tube bracket as shown.



21. Install the K&N® intake tube into the silicone hump hose and then into the throttle body silicone hose. Install the tube bracket onto the mounting stud and secure it to the K&N® intake tube with the provided hardware. Tighten the hose clamps at this time.



22. Reconnect the inlet air temperature sensor electrical connection.

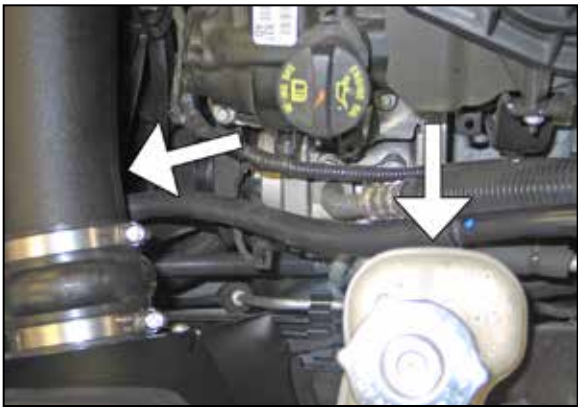

23. Install the provided silicone hose onto the factory crank case vent tube and then connect the open end to the 90° fitting installed into the K&N® intake tube.  
**NOTE: On later model vehicles that the CCV connection is near the throttle body, it will be necessary to use the provided quick connect fitting and longer CCV hose.**



24. Install the K&N® air filter and secure with the provided hose clamp.  
**NOTE: Drycharger® air filter wrap; part # RF-1042DK is available to purchase separately. To learn more about Drycharger® filter wraps or look up color availability please visit <http://www.knfilters.com>.**



25. Reconnect the vehicle's negative battery cable. Double check to make sure everything is tight and properly positioned before starting the vehicle.  
  
26. It will be necessary for all K&N® high flow intake systems to be checked periodically for realignment, clearance and tightening of all connections. Failure to follow the above instructions or proper maintenance may void warranty.