



INSTALLATION INSTRUCTIONS

Legal for use in all 50 states.

57-1572 CHRYSLER 2015-16 200 V6-3.6L

TOOLS NEEDED:

Ratchet
Extension
10mm Socket
Flat Blade Screw Driver

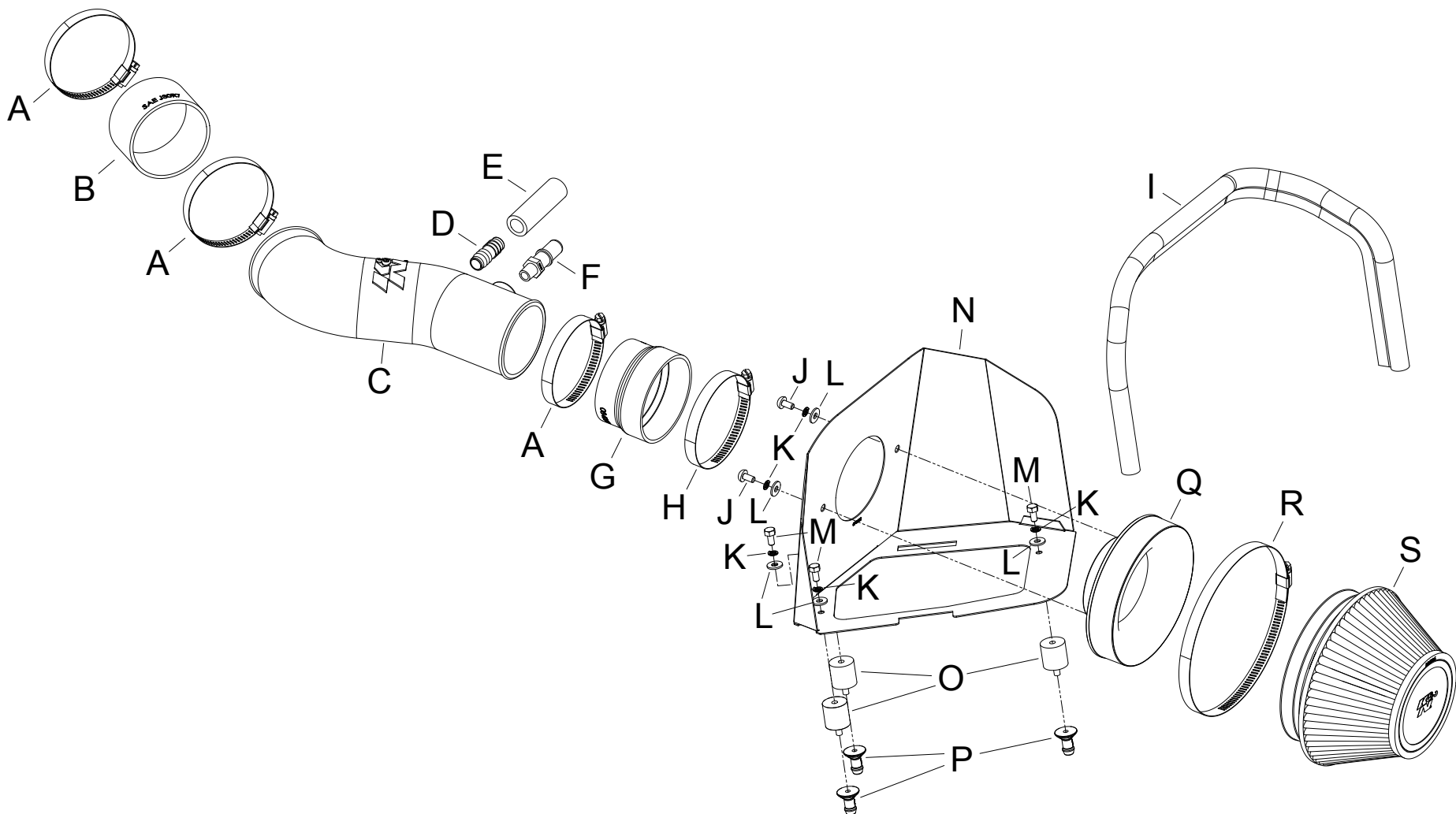

PARTS LIST:

Description	Qty.	Part #	Description	Qty.	Part #	Description	Qty.	Part #
A HOSE CLAMP #52	3	08610	H HOSE CLAMP #56	1	08620	O STUD; M6 X 1, RUBBER MNT.	3	02033
B HOSE; 3.25" ID X 2" L	1	08690	I EDGE TRIM; (26"L)	1	102488	P MOUNT, PLASTIC AIRBOX	3	8-186-1
C INTAKE TUBE; (JT)	1	087288A	J BOLT; M6-1 X 12MM, BTNHD	2	07794	Q ADAPTER; UNIVERSAL, 6"	1	21512-1
D VENT; STRT, 5/8"HOSE - 5/8"	1	08048	K WASHER, M6 SPLIT LOCK ZINC	5	1-3025	R HOSE CLAMP #104	1	08697
E HOSE; 5/8"ID X 3"L	1	5-7003	L WASHER; 6MM FLAT	5	08269	S AIR FILTER	1	RU-4600
F VENT; 1/4 NPT TO QUICK	1	082628	M BOLT; M6 X 1 X 12MM, HEXHD	3	07727			
G HOSE; 3.25"ID TO 3.5"ID X 2.25"	1	084091	N HEAT SHIELD	1	073208			

If you need any assistance please call 1-800-858-3333 to speak with a representative in our Customer Service Center before returning the product.

NOTE: FAILURE TO FOLLOW INSTALLATION INSTRUCTIONS AND NOT USING THE PROVIDED HARDWARE MAY DAMAGE THE INTAKE TUBE, THROTTLE BODY AND ENGINE.

TO START:

1. Turn off the ignition and disconnect the negative battery cable.
NOTE: Disconnecting the negative battery cable erases pre-programmed electronic memories. Write down all memory settings before disconnecting the negative battery cable. Some radios will require an anti-theft code to be entered after the battery is reconnected. The anti-theft code is typically supplied with your owner's manual. In the event your vehicles anti-theft code cannot be recovered, contact an authorized dealership to obtain your vehicles anti-theft code.



2. Lift off the decorative engine cover.



3. Loosen the hose clamp that secures the factory intake tube to the intake plenum.



4. Depress the locking tab and then disconnect the crank case vent hose assembly from the air filter housing.



5. Separate the factory intake tube from the intake plenum and then lift up the complete upper air filter housing to dislodge it from the mounting grommets and remove it from the vehicle.

NOTE: K&N Engineering, Inc., recommends that customers do not discard factory air intake.



6. Install the provided air filter adapter into the heat shield and secure with the provided hardware.



7. Install the three provided heat shield mounting studs onto the rubber mounted studs as shown.

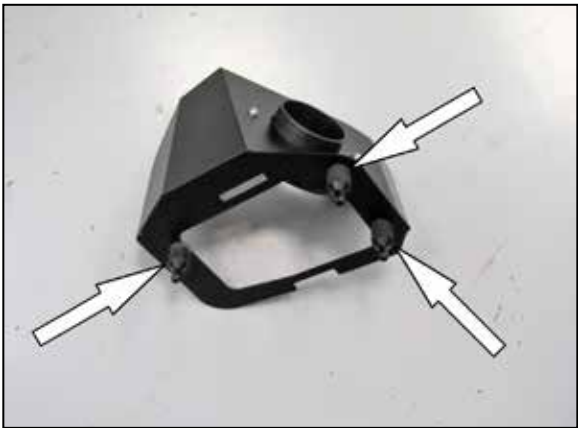

8. Install the mounting stud assemblies onto the heat shield and secure with the provided hardware.



9. Install the provided edge trim onto the heat shield as shown.

NOTE: Some trimming of the edge trim will be necessary.



10. Install the heat shield assembly so that the mounting studs engage with the factory mounting grommets.



11. Install the provided coupling hose (08690) onto the intake plenum and secure with the provided hose clamp.



12. Install the provided coupler hose (084091) onto the K&N intake tube fully but do not tighten at this time.



13. Install the provided quick disconnect npt fitting into the K&N intake tube as shown.
NOTE: NPT fittings are easy to cross thread. Install the vent fitting "hand" tight, then turn it two complete turns with a wrench.



14. Install the provided hose mender into the section of crank case vent hose provided.



15. Remove the factory quick disconnect fitting from the factory crank case vent hose and install it into the provided vent hose as shown.



16. Install the K&N intake tube into the coupling hose at the plenum, align the coupling hose at the filter adapter and then adjust the tube for best fit and tighten all of the hose clamps.



17. Install the crank case quick connect fitting into the factory crank case vent hose and connect it to the fitting installed into the K&N intake tube.
NOTE: Trim the provided hose as needed and adjust so that there are not any kinks in the hose.



18. Install the K&N air filter onto the filter adapter and secure with the provided hose clamp.



19. Reinstall the decorative engine cover.



20. Reconnect the vehicle's negative battery cable. Double check to make sure everything is tight and properly positioned before starting the vehicle.

21. The C.A.R.B. exemption sticker, (attached), must be visible under the hood so that an emissions inspector can see it when the vehicle is required to be tested for emissions. California requires testing every two years, other states may vary.

22. It will be necessary for all K&N® high flow intake systems to be checked periodically for realignment, clearance and tightening of all connections. Failure to follow the above instructions or proper maintenance may void warranty.

ROAD TESTING:

1. Start the engine with the transmission in neutral or park, and the parking brake engaged. Listen for air leaks or odd noises. For air leaks secure hoses and connections. For odd noises, find cause and repair before proceeding. This kit will function identically to the factory system except for being louder and much more responsive.
2. Test drive the vehicle. Listen for odd noises or rattles and fix as necessary.
3. If road test is fine, you can now enjoy the added power and performance from your kit.
4. K&N Engineering, Inc., requires cleaning the intake system's air filter element every 100,000 miles. When used in dusty or off-road environments, our filters will require cleaning more often. We recommend that you visually inspect your filter once every 25,000 miles to determine if the screen is still visible. When the screen is no longer visible some place on the filter element, it is time to clean it. To clean and re-oil, purchase our filter Recharger® service kit, part number 99-5050 or 99-5000 and follow the easy instructions.