



INSTALLATION INSTRUCTIONS

Not legal for sale or use in California on any pollution controlled motor vehicle.

50-1592D RAM 2013-2018 2500 L6-6.7L TURBO DIESEL

NOTE: This kit was not designed to fit vehicles with a body lift.

TOOLS NEEDED:

- 1/4" Ratchet
- 13mm socket
- 10mm socket
- 7mm socket
- T27 torx bit
- Flat head screwdriver
- 4mm allen key
- 3mm allen key
- 2.5mm allen key
- Panel popper

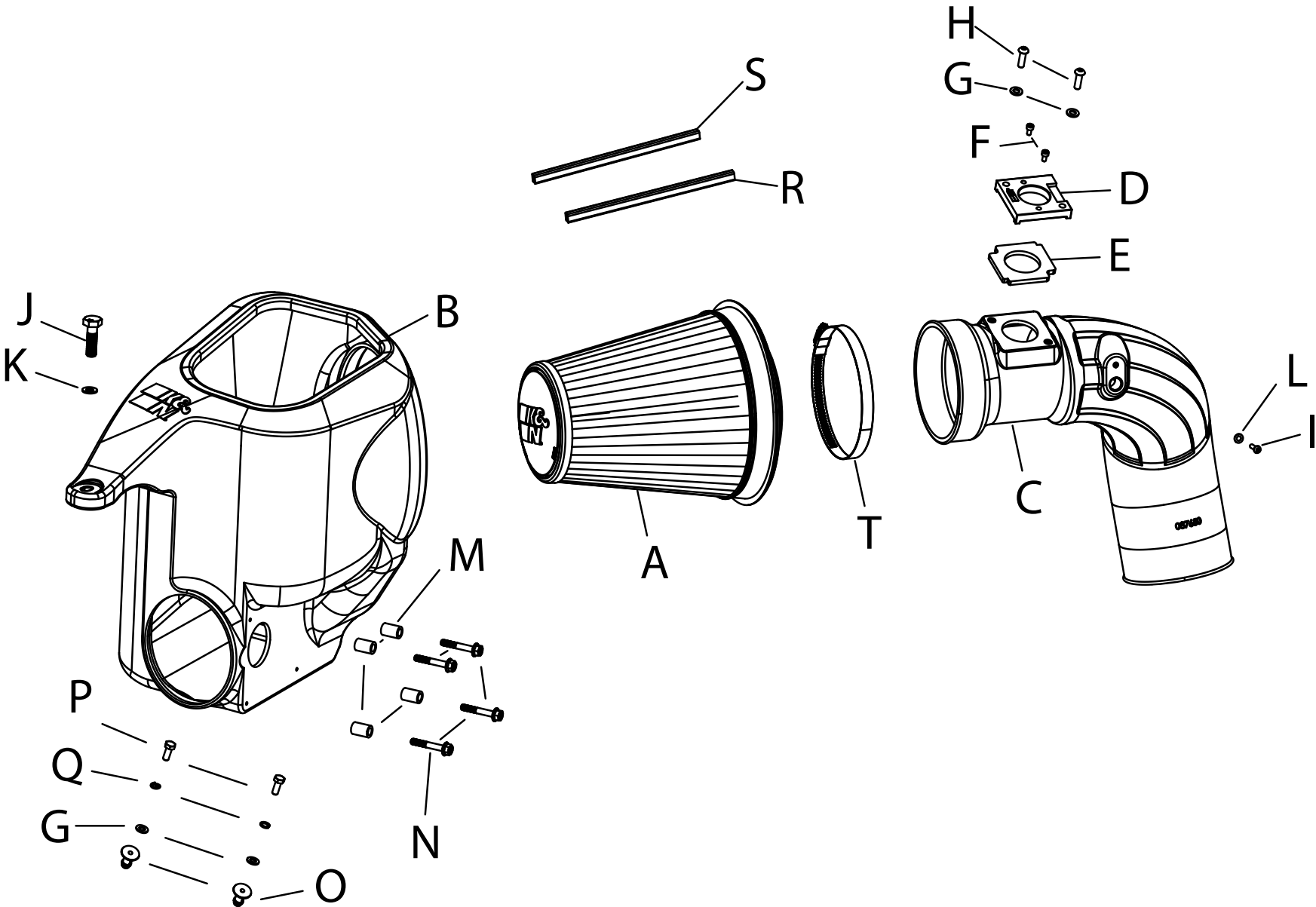

PARTS LIST:

Description	Qty.	Part #	Description	Qty.	Part #	Description	Qty.	Part #
A AIR FILTER DRY	1	RU-3138HBK	H SCREW; M6 X 20MM	2	KIT20BHC3060	O MOUNT; PLASTIC NYLON	2	8-186-1
B AIR BOX	1	087649	I SCREW; M4-.7 X 16MM	1	07793	P BOLT; M6-1 X 16MM	2	07812
C TUBE	1	087650	J BOLT; 8MM-1.25 X 35MM	1	07784	Q WASHER; M6, SPLIT LOCK	2	1-3025
D ADAPTOR; MASS AIR SENSOR	1	21507	K WASHER; 8MM, FLAT	1	08272	R CLIP; SNAP ON RED	1	088220
E GASKET; 3/16" PORON	1	09074	L WASHER; 4MM FLAT	1	08278	S CLIP; SNAP ON ORANGE	1	088221
F BOLT; M4-.7 X 8MM, ALNHD CAP	2	07733	M SPACER; 1/2"OD X 5/16"ID	4	06558	T HOSE CLAMP; #88 BLK	1	KITHS88K
G WASHER; 6MM FLAT	4	08269	N BOLT; M6-1 X 40 HEX	4	1-2075			

If you need any assistance please call 1-800-858-3333 to speak with a representative in our Customer Service Center before returning the product.

NOTE: FAILURE TO FOLLOW INSTALLATION INSTRUCTIONS AND NOT USING THE PROVIDED HARDWARE MAY DAMAGE THE INTAKE TUBE, THROTTLE BODY AND ENGINE.

TO START:

1. Turn off the ignition and disconnect the negative battery cable.
NOTE: Disconnecting the negative battery cable erases pre-programmed electronic memories. Write down all memory settings before disconnecting the negative battery cable. Some radios will require an anti-theft code to be entered after the battery is reconnected. The anti-theft code is typically supplied with your owner's manual. In the event your vehicles anti-theft code cannot be recovered, contact an authorized dealership to obtain your vehicles anti-theft code.



2. Loosen the hose clamp that secures the factory intake tube to the air filter housing. Disconnect the air sensor electrical connections.



3. Loosen the three bolts that secure the air filter housing lid and then remove the lid.



4. Remove the bolt that secures the lower air filter housing to the core support.



5. Lift the lower air filter housing up enough to gain access to the diverter door electrical connection, disconnect the diverter door electrical connection, and then remove the lower air filter housing.



6. Loosen the hose clamp that secures the factory intake tube silencer to the turbo inlet elbow then remove intake tube .

NOTE: K&N Engineering, Inc., recommends that customers do not discard factory air intake.



7. Remove the four bolts that secure the diverter door motor to the lower air filter housing.



8. Pull the diverter door motor partially out of the air filter housing, then using a panel popper tool or similar device to pry the diverter door off the motor shaft.



9. Install the fresh air diverter motor into the K&N air filter housing. Secure the door motor only to the housing using the provided spacers and hardware.



10. Install the mounting studs onto the K&N air filter housing using the provided hardware.



11. Remove the mass air sensor and IAT sensor from the factory housing. Install the IAT sensor into the K&N intake tube using the provided hardware. Install the provided gasket onto the provided mass air sensor adapter, then install the mass air sensor into the adapter using the provided hardware. Now install the mass air sensor assembly onto the K&N intake tube using the provided hardware as shown. **NOTE: Make sure the sensor is going in the correct direction.**



12. Attach the filter clips to the pleats on the air filter align and push down. Passenger side filters, place orange clip on top and red on bottom.



13. Install the filter into the airbox. Now install the intake tube into the filter and position like image shown above.



14. Partially install the housing and connect the diverter door motor electrical connection. Now install the K&N air filter housing into the vehicle so the mounting studs insert into the mounting grommets. Adjust intake tube into the turbo inlet elbow from step 6 and tighten clamp.



15. Secure the front of air box using provided hardware.



16. Reconnect the mass air sensor and IAT sensor electrical connections.



17. Reconnect the vehicle's negative battery cable. Double check to make sure everything is tight and properly positioned before starting the vehicle.

18. **K&N AIR FILTER MONITOR LIGHT:** Some vehicles are equipped with a "Air Filter Monitor" system that will send a message to the instrument cluster indicating that the air filter needs to be replaced. This system is calibrated for the OEM intake system and air filter and will not be accurate when K&N products are in use. Always refer to WWW.KNFILTERS.COM for K&N air filter service procedures. The "Air Filter Monitor" system must be disabled to prevent the monitor from setting on and causing a factory dealership visit to rest the system. Follow the "Air Filter Monitor" system procedure listed in the factory owners manual.

19. It will be necessary for all K&N® high flow intake systems to be checked periodically for realignment, clearance and tightening of all connections. Failure to follow the above instructions or proper maintenance may void warranty.

ROAD TESTING:

1. Start the engine with the transmission in neutral or park, and the parking brake engaged. Listen for air leaks or odd noises. For air leaks secure hoses and connections. For odd noises, find cause and repair before proceeding. This kit will function identically to the factory system except for being louder and much more responsive.
2. Test drive the vehicle. Listen for odd noises or rattles and fix as necessary.
3. If road test is fine, you can now enjoy the added power and performance from your kit.
4. K&N Engineering, Inc., requires cleaning the intake system's air filter element every 50,000 miles. When used in dusty or off-road environments, our filters will require cleaning more often. We recommend that you visually inspect your filter once every 25,000 miles to determine if the screen is still visible. When the screen is no longer visible some place on the filter element, it is time to clean it. To clean, purchase our Synthetic Filter Cleaner, part number 99-0624 and follow the easy instructions.