



# INSTALLATION INSTRUCTIONS

Not legal for sale or use in California on any pollution controlled motor vehicle.

## 50-1583D RAM 2019-24 2500/3500 L6-6.7L Turbo Diesel

### TOOLS NEEDED:

- Flat blade screw driver
- Ratchet
- Extension
- 13mm wrench
- 13mm socket
- 8mm socket
- 10mm socket
- 2.5mm allen key
- 3mm allen key
- 4mm allen key
- T15 torx

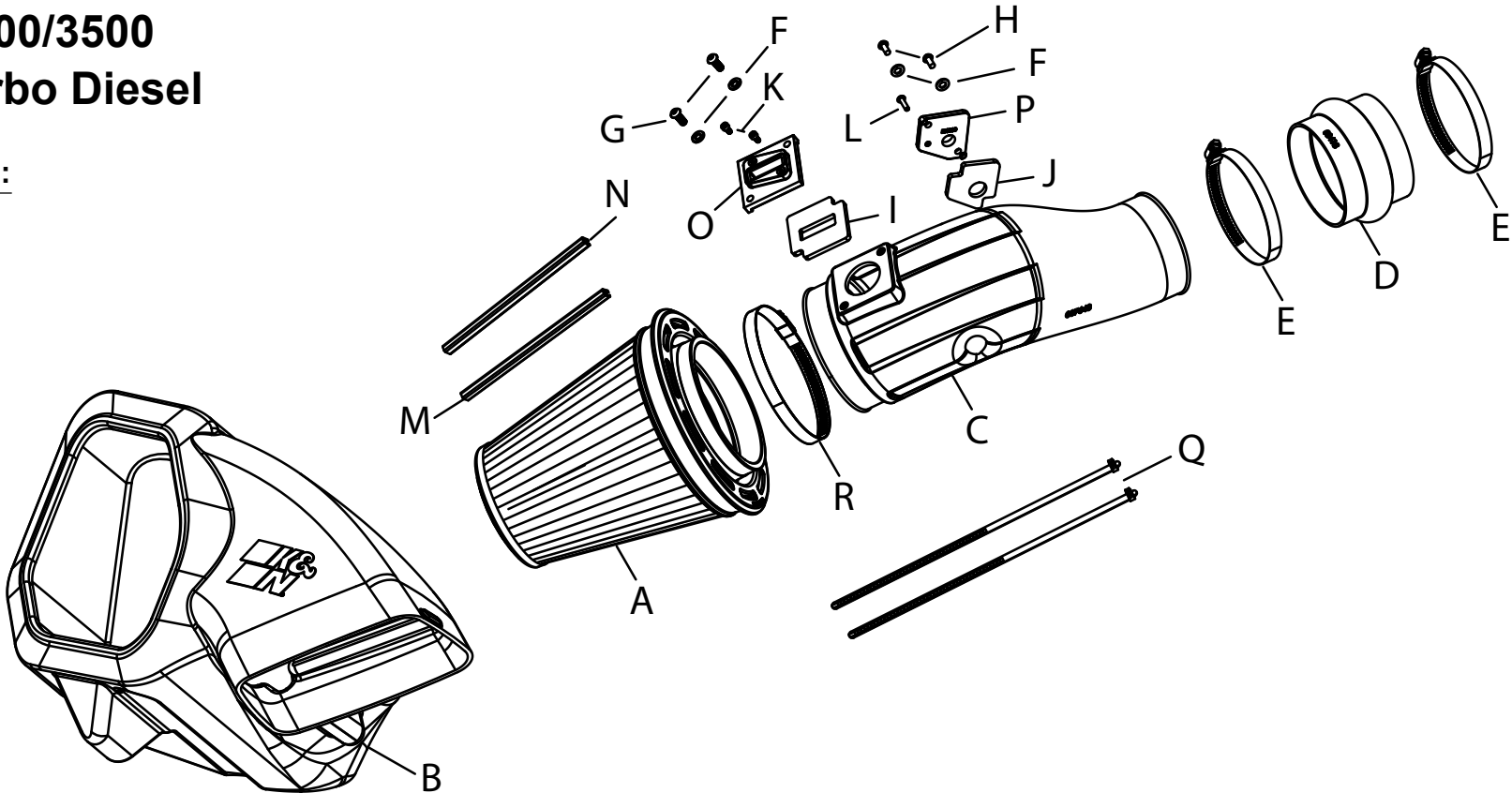

### PARTS LIST:

Description	Qty.	Part #	Description	Qty.	Part #	Description	Qty.	Part #
A AIR FILTER DRY	1	RU- 3138HBK	G BOLT; M6 X 1.00 X 16MM	2	07730	M CLIP; SNAP-ON, RED	1	088220
B AIR BOX	1	087647	H BOLT; M5 X .8 X 12MM	2	07734	N CLIP; SNAP-ON, ORANGE	1	088221
C TUBE	1	087648	I GASKET; PORON MAF	1	09069	O ADAPTER; MAF SENSOR	1	088032
D HOSE; HUMP 4"ID X 3"L	1	08418	J GASKET; TEMP SENSOR	1	09771	P ADAPTER; TEMP SENSOR	1	088021
E HOSE CLAMP; #64 BLK	2	08645KA	K BOLT; M4 - 0.07 8MM	2	07733	Q CABLE TIES; 11" BLACK	2	21590
F WASHER; 6MM FLAT	4	08269	L SCREW; M4-.7 X 16MM	1	07793	R HOSE CLAMP; #88 BLK	1	KITHS88K

If you need any assistance please call 1-800-858-3333 to speak with a representative in our Customer Service Center before returning the product.

**NOTE: FAILURE TO FOLLOW INSTALLATION INSTRUCTIONS AND NOT USING THE PROVIDED HARDWARE MAY DAMAGE THE INTAKE TUBE, THROTTLE BODY AND ENGINE.**



### TO START:

- Turn off the ignition and disconnect the negative battery cables.  
**NOTE: Disconnecting the negative battery cable erases pre-programmed electronic memories. Write down all memory settings before disconnecting the negative battery cable. Some radios will require an anti-theft code to be entered after the battery is reconnected. The anti-theft code is typically supplied with your owner's manual. In the event your vehicles anti-theft code cannot be recovered, contact an authorized dealership to obtain your vehicles anti-theft code.**

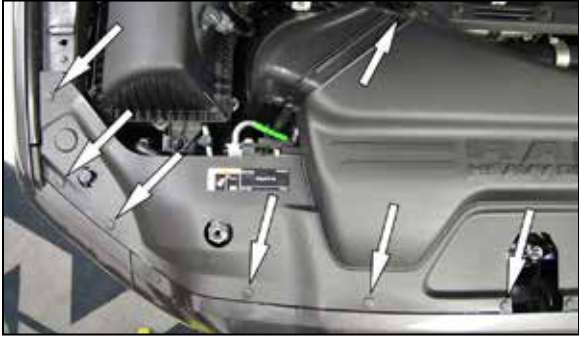

- Remove the 14 push clips that secure the upper core support plastic cover and then remove the cover from the vehicle.



- Remove the two bolts that secure the fresh air inlet duct to the core support, then remove the inlet from the vehicle.



- Loosen the hose clamp that secures the intake tube to the air filter housing and disconnect the electrical connections of the two air sensors.





5. Remove the complete air filter housing from the vehicle as shown.  
**NOTE: K&N Engineering, Inc., recommends that customers do not discard factory air intake.**



6. Loosen the hose clamp that secures the factory intake tube to the turbo inlet, then remove the tube from the vehicle.

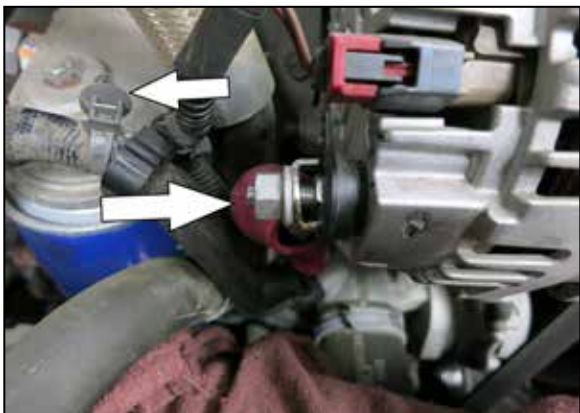
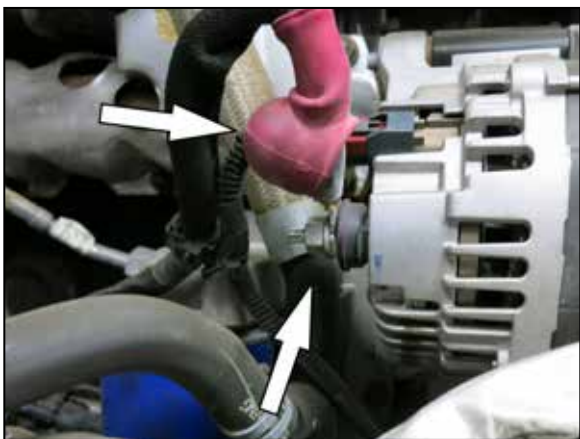

7. **NOTE: Make sure the vehicles battery is completely disconnected! You may come in contact with engine or tools to ground and possibly arc!!** Locate the positive terminal on the back of the alternator. Slide terminal cover and pull away. Place a towel or rag on any hard ground engine components, then loosen the terminal. Pull terminal back and flip 180 degrees. Re-install so the terminal is facing down. Positive terminal does have 2 locating tabs. Make sure it seats correctly.  
**NOTE: Positive terminal may have a cable-tie attached at engine, pull away for easier access when rotating.**



8. Secure and tighten the positive terminal on alternator. Slide and position the terminal cover.



9. Remove both temperature and MAF sensor from the air box.



10. Install the provided gaskets onto the bottom of the two air sensor adapters provided.



11. Install the MAF and temperature sensors into the K&N® sensor adapters using the provided hardware.



12. Install the MAF sensor and temperature assembly into the intake tube and secure using provided hardware. Secure and tighten. **NOTE: Make sure the sensor is going in the correct direction.** If it is not installed in the correct orientation, remove the adapter bolts and spin 180 degrees then reinstall the bolts.



13. Install the hump hose with clamps to the turbo. Tighten clamp on turbo only.



14. Install intake tube assembly into vehicle and position like image shown. Do not tighten.



15. Remove the 3 factory grommets from the factory airbox and re-install into the K&N® airbox.



16. Attach the filter clips to the pleats on the air filter, align them and push down. Passenger side filters, place orange clip on top and red on bottom.





17. Install the K&N air filter into the K&N air filter housing.



18. Now install the K&N air filter housing into the vehicle so the mounting studs insert into the mounting grommets, at the same time aligning the intake tube into filter.



19. Once intake tube is positioned, tighten remaining 2 clamps.



20. Reconnect the mass air sensor and IAT sensor electrical connections. Cable-ties provided to secure harness if necessary.



21. Re-install the fresh air duct and secure.



22. Re-install the upper core support plastic cover.



23. Reconnect the vehicle's negative battery cable. Double check to make sure everything is tight and properly positioned before starting the vehicle.

24. It will be necessary for all K&N® high flow intake systems to be checked periodically for realignment, clearance and tightening of all connections. Failure to follow the above instructions or proper maintenance may void warranty.

**ROAD TESTING:**

1. Start the engine with the transmission in neutral or park, and the parking brake engaged. Listen for air leaks or odd noises. For air leaks secure hoses and connections. For odd noises, find cause and repair before proceeding. This kit will function identically to the factory system except for being louder and much more responsive.
2. Test drive the vehicle. Listen for odd noises or rattles and fix as necessary.
3. If road test is fine, you can now enjoy the added power and performance from your kit.
4. K&N Engineering, Inc., requires cleaning the intake system's air filter element every 50,000 miles. When used in dusty or off-road environments, our filters will require cleaning more often. We recommend that you visually inspect your filter once every 25,000 miles to determine if the screen is still visible. When the screen is no longer visible some place on the filter element, it is time to clean it. To clean, purchase our Synthetic Filter Cleaner, part number 99-0624 and follow the easy instructions.